

ROTARY VALVES

TYPE RF

- **FABRICATED ROTARY VALVE**
- **MILD STEEL OR STAINLESS STEEL CONSTRUCTION**
- **CUSTOM APETURE SIZES AVAILABLE**

Britton Procol standard fabricated rotary valves are designed for use with low density products such as wood shavings and textile fibres. They provide an economic solution for applications which require high feed rates of low-density products.

The valve body is fabricated from sheet steel or stainless steel and fitted with 6 blade rotor having replaceable reinforced rubber blades.

Drive is by a worm geared motor, flange mounted from the valve endplate and direct coupled to the rotor shaft.

Capacities for standard fabricated rotary valves are identical to the equivalent cast rotary valves.

Special valves are available for use with moderately aggressive products such as fibreglass strands or filled PVC granules. For these applications, the valve body is fabricated from abrasion resistant steel or stainless steel.

Fabricated rotary valves are available in standard sizes as shown in the data sheet and also in non-standard sizes up to a maximum rotor size of Ø1000mm x 2000mm long.

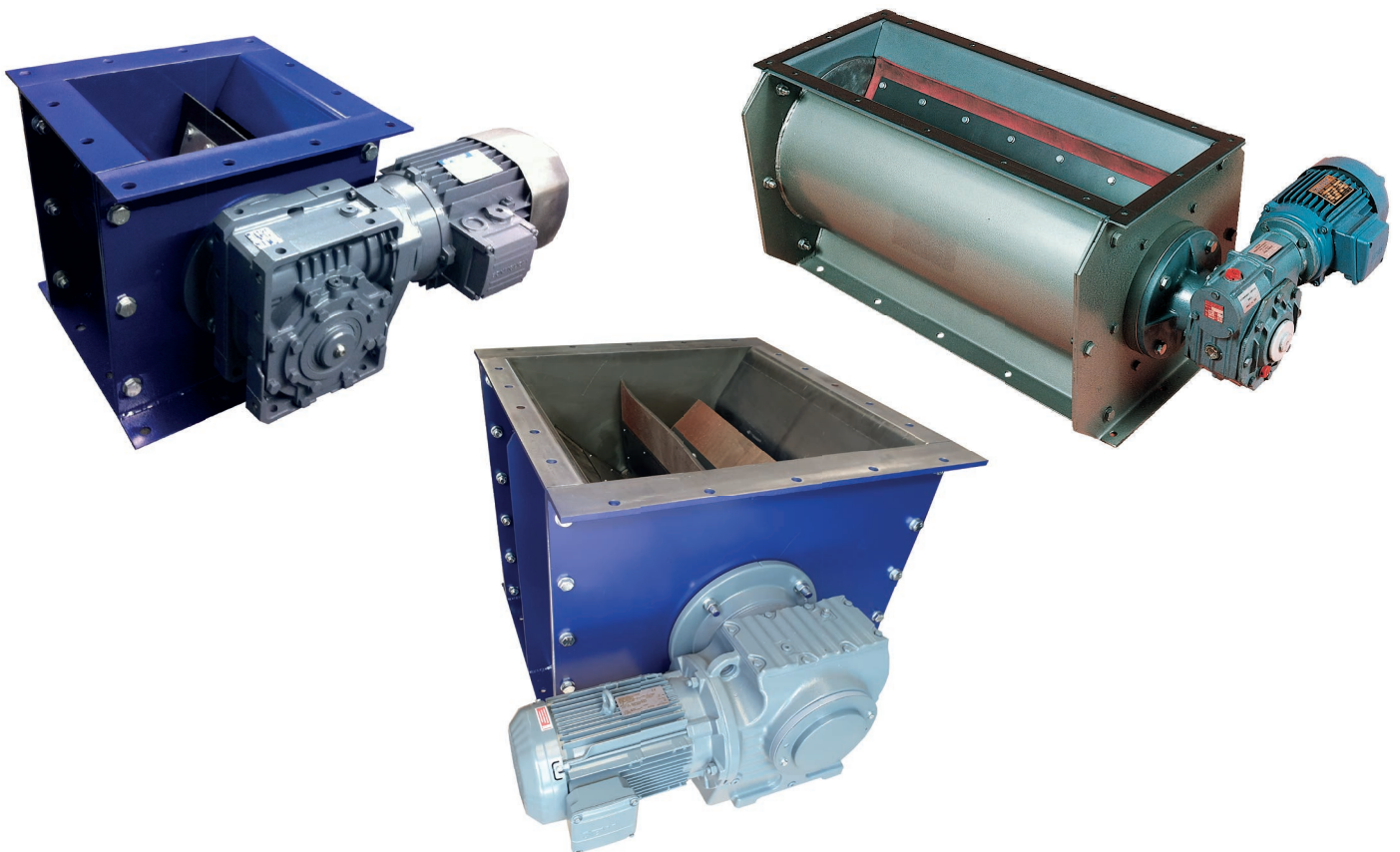

BRITTON PROCOL VALVES

WRIGHTS DOWSON GROUP

*See over for
planning-in
dimensions*

Kynochs Industrial Estate Bideford Devon EX39 4DT

T: 01237 477465 E: sales@brittonprocol.com

www.brittonprocol.com

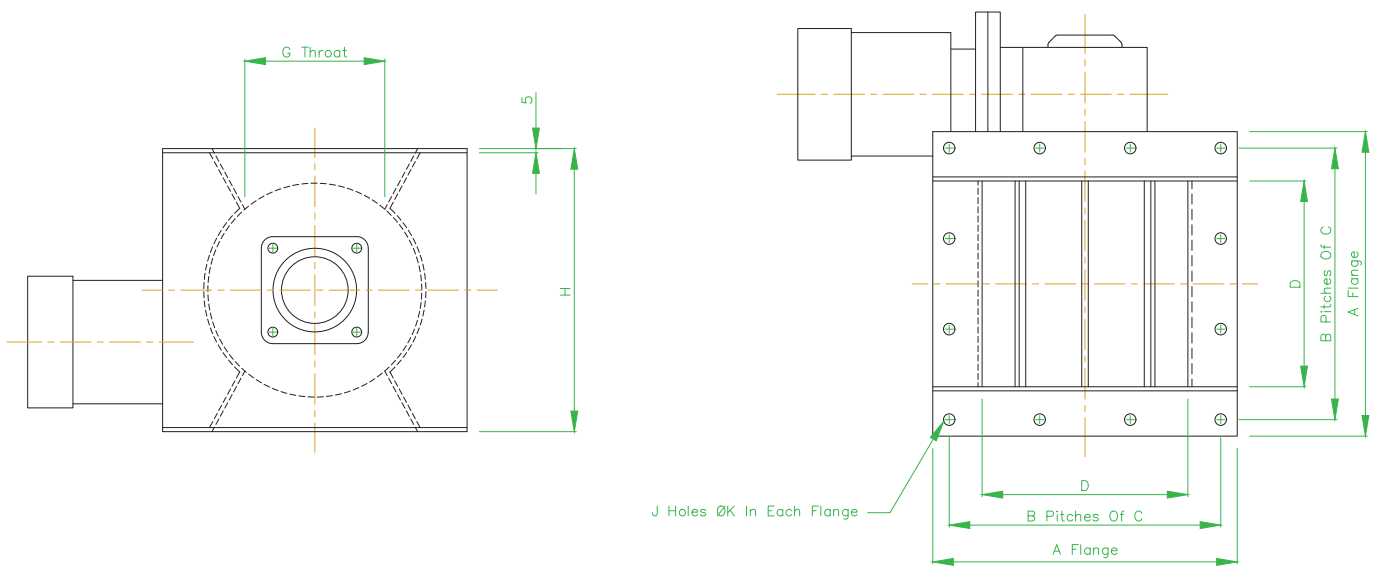

VALVE SIZE	A	B	C	D	G	H	Drive Kw	Weight Kg
125	225	2	93	125	86	210	0.37	40
150	250	2	105	150	100	240	0.37	50
200	320	2	140	200	140	300	0.37	65
250	370	3	110	250	170	344	0.75	95
300	420	3	126	300	200	450	0.75	125
350	490	3	146	350	240	500	0.75	150
400	540	4	122	400	280	550	1.1	200
500	640	4	147	500	355	650	1.5	275
600	750	4	175	600	410	765	2.2	350

We are continually developing our products and accordingly we reserve the right to change specifications and dimensions without prior notice.



BRITTON PROCOL VALVES

WRIGHTS DOWSON GROUP

Kynochs Industrial Estate Bideford Devon EX39 4DT

T: 01237 477465 E: sales@brittonprocol.com

www.brittonprocol.com